

INTOUCH270

BY INSTORESCREEN

Instorescreen's INTOUCH270 is our monitor for signage and menu boards. It is ideal as POS enhancer and close to customer service and experience.

- INTOUCH270 mounts easily with adjustable brackets, vertically or horizontally.
- Toughened back printed glass for easy cleaning and maintenance.
- 10 point in-cell touch
- VESA 75 by 75 and 100 by 100 mount on the back side.
- HDMI and USB-C input for most computers.
- Anti-microbial coating.
- Sturdy aluminum chassis, environmental friendly.
- Perfect choice in combination with Lenovo Nano and Tiny series.

NOTE: Due to our policy "as little waste as possible" this product is shipped without data and mains cable

SPECIFICATIONS:

Resolution: 3840 X 2160
Colors: 1.07 B
Viewing angle: 89/89/89/89
Contrast ratio: 1000:1
Brightness: 350 cd/m2
Power consumption: DC 12V 27W
Video input: HDMI, USB-C
Weight: Approx. 7 kg



CERTIFICATIONS:

Unit: CE, FCC, ROHS
Power supply: CE, FCC, ROHS, UL

PART NUMBER: INT270TKX-GL-A1.0-B/S
B: Black anodization and black glass border
S: Silver anodization and white glass border

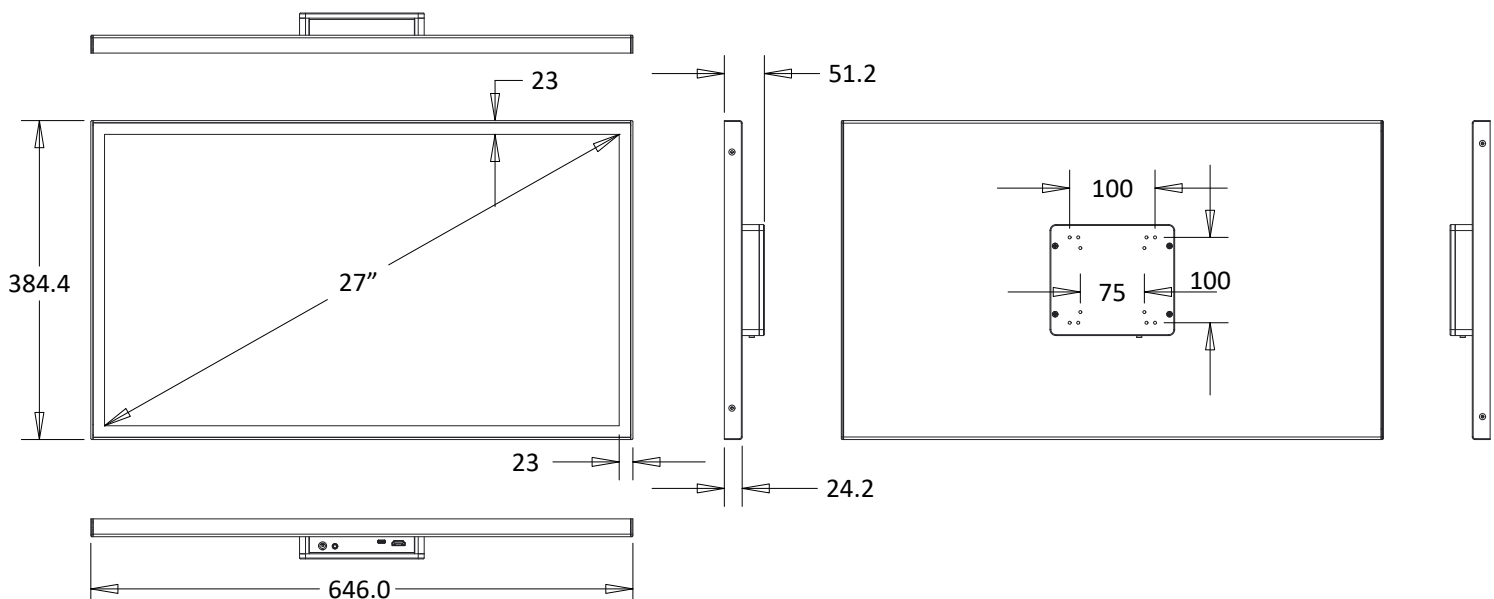
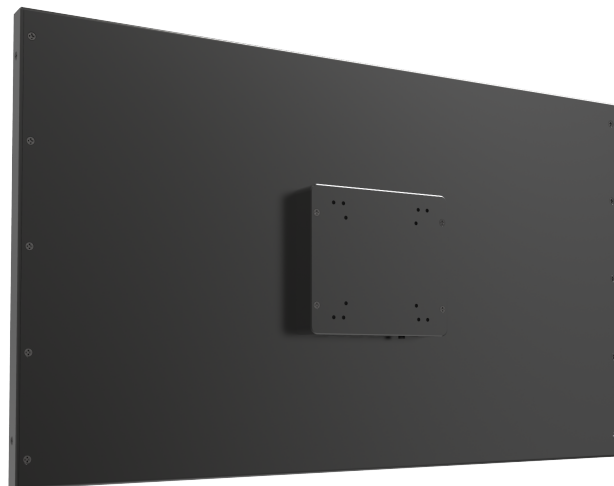

INSTORE
SCREEN™



LENOVO P/N BLACK 40EMTD1006

INTOUCH270

BY INSTORESCREEN

CERTIFICATIONS:

Unit: CE, FCC, ROHS
Power supply: UL, CE, FCC, ROHS



PART NUMBER: INT270TKX-GL-A1.0-B/S

AUDIO IN/OUT

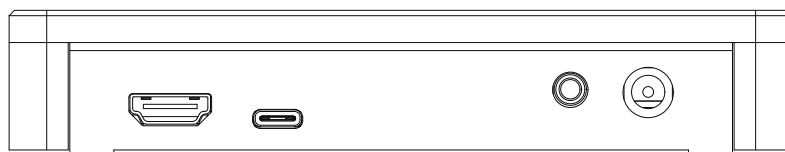

HDMI IN USB-C IN

POWER IN

MONITOR SPECIFICATIONS:

Enclosure color:	Normally black
Monitor width:	27"
Monitor thickness:	46.9 mm
Aspect ratio:	16:9
Active area:	594.888(H) x 336.312(V)
Resolution:	3840 X 2160, 4K
Viewing angle:	89/89/89/89
Numbers of colors:	1.07 B
Brightness:	300cd/m2
Response time:	20 ms
LED life time	30000 h
Contrast ratio:	1000:1
Surface treatment:	Tempered glass, anti microbial
Video in:	1 x HDMI, 1 x USB-C
Power:	12V 5A
Power consumption:	27W
Monitor dimensions:	646 (W) 384.4 (H) 51.2 (D)
Weight:	Approx. 7 kg
Weight packed:	Approx. 8 kg
Shipping box dimensions:	Approx. 700 (W) 465 (H) 95 (D)
Operating temperature:	10°C to 40°C / 50°F to 104°F
Storage temperature:	-20°C to 60°C / -4°F to 140°F
Operating humidity:	20% to 80%
Storage humidity:	0% to 95%
Mounting options:	VESA 100 x 100 and 75 x 75 mm

TOUCH SPECIFICATIONS:

PCAP:	10 touch
Interface:	USB-C

USB INTERFACES:

USB-C	OSD and RS232 commands
-------	------------------------

WARRANTY:

Warranty:	3-year
Extended Warranty Option:	Yes

Whats in the box

Monitor:	inTouch270
Power brick:	12V 5A no cable
Mounting:	Mounting instructions

Operating systems

Windows:	10 / 8 / 7 @ HD 30 / 60 Hz
Linux:	All, running HD 30 / 60 Hz
Andoid:	All, running HD 30 / 60 Hz

Installation guide

Web based guide	https://
-----------------	---------------------------------

INSTORE
SCREEN™



LENOVO P/N BLACK 40EMTD1006